



Concealed Fastener & 28° Latch

Concealed Fastener Mechanism

Sleek concealed fastener system with no exposed screws. Available for all Brass, Stainless Steel, Bronze, Crystal, and Porcelain interior passage and privacy locksets.



Key Features

- Fits a standard 2 1/8" door prep
- Fits door thickness from 1 3/8" to 1 3/4", extended door thicknesses can be accommodated up to 2 3/4" when specified
- Choice of 2 3/8" or 2 3/4" backset
- No handing required
- Easy, simple installation
- Lifetime Limited Mechanical Warranty

CF Mechanism

Concealed Fasteners and 28° Latch

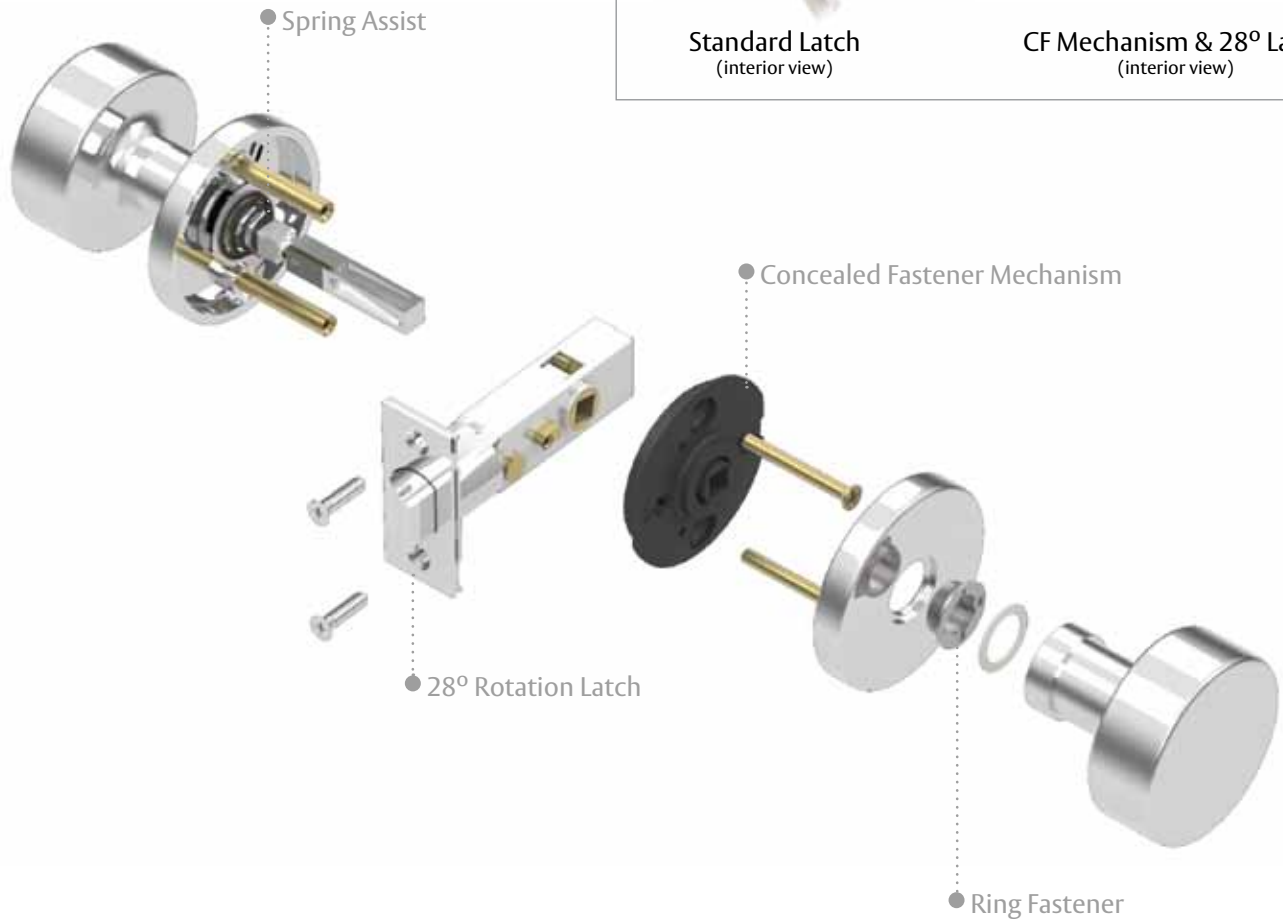
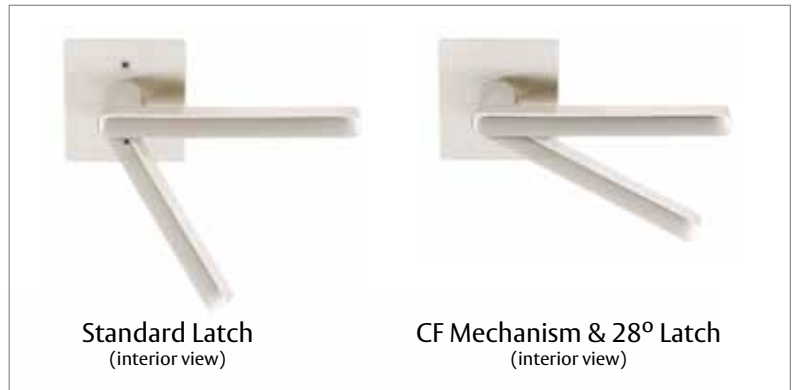

Elegance by Design

Adopt a concealed fastener mechanism and a geared, limited rotation latch as an option for Emtek passage and privacy locksets. With more than 4,000 design combinations available, you'll be sure to find the perfect complement to your décor.

Easy Installation

Emtek's CF Mechanism is quick and easy to install. Ordering is also simple, no handing is required.

Lifetime Functionality

Emtek's innovative chassis design is spring loaded on both sides and comes standard with a 28° rotation latch. Operation is smooth and long term reliability is ensured. Every CF Mechanism is backed by Emtek's CF Mechanism Lifetime Limited Mechanical Warranty.

CF Mechanism

Concealed Fasteners and 28° Latch

Hercules Lever
with Square Rosette
Polished Chrome



Geneva Lever
with Neos Rosette
Satin Nickel



Stuttgart Lever
with Disk Rosette
Polished Chrome



Bern Knob
with Square Rosette
Satin Nickel



Triton Lever
with Disk Rosette
Satin Nickel



Helios Lever
with Square Rosette
Polished Chrome



Modern Brass

Square Knob
with Disk Rosette
Oil Rubbed Bronze



Round Knob
with Square Rosette
Satin Nickel



Orb Knob
with Square Rosette
PVD-Lifetime



Basel Lever
with Modern Rosette
PVD-Lifetime



Hercules Brown Leather Lever
with Square Rosette
Oil Rubbed Bronze



Hercules Black Leather Lever
with Disk Rosette
Satin Nickel



CF Mechanism

Concealed Fasteners and 28° Latch



Modern Brass



CF Mechanism

Concealed Fasteners and 28° Latch

Milano Lever
with Rectangular Rosette
Satin Nickel

Waverly Knob
with Oval Rosette
Satin Nickel

Rustic Lever
with Regular Rosette
Polished Brass

Egg Knob
with Oval Rosette
Polished Brass

Norwich Knob
with Ribbon & Reed Rosette
Satin Nickel

Aireon Lever
with Regular Rosette
Satin Nickel

Classic Brass

Providence Knob
with Ribbon & Reed Rosette
Pewter

Cortina Lever
with Regular Rosette
Pewter

Rope Knob
with Rope Rosette
Oil Rubbed Bronze

Rope Lever
with Rope Rosette
Oil Rubbed Bronze

Turino Lever
with Lancaster Rosette
Pewter

CF Mechanism

Concealed Fasteners and 28° Latch



Designer Brass



CF Mechanism

Concealed Fasteners and 28° Latch



Crystal & Porcelain



CF Mechanism

Concealed Fasteners and 28° Latch



Stainless Steel



CF Mechanism

Concealed Fasteners and 28° Latch



Durango Lever
with #1 Rosette
Medium Bronze

Montrose Lever
with #3 Rosette
Medium Bronze

Cimarron Lever
with #4 Rosette
Silver Patina

Winchester Knob
with #2 Rosette
Flat Black

Sandcast Bronze



Egg Knob
with #1 Rosette
Medium Bronze

Teton Lever
with #2 Rosette
Medium Bronze

Butte Knob
with #1 Rosette
Medium Bronze

Cody Lever
with #3 Rosette
Medium Bronze

Aurora Lever
with #4 Rosette
Deep Burgundy

CF Mechanism

Concealed Fasteners and 28° Latch



Octagon Lever
with #15 Rosette
Medium Bronze

Medici Lever
with #14 Rosette
Medium Bronze

**Dakota Black
Leather Lever**
with #11 Rosette
Deep Burgundy

Napoli Lever
with #12 Rosette
Deep Burgundy

Petal Knob
with #12 Rosette
Flat Black

Tuscany Bronze



Art Nouveau Knob
with #17 Rosette
Medium Bronze

Parma Knob
with #14 Rosette
Medium Bronze

Padua Lever
with #11 Rosette
Silver Patina

Art Nouveau Lever
with #17 Rosette
Medium Bronze

Octagon Knob
with #15 Rosette
Medium Bronze



Scan to learn more
about CF Mechanism



EMTEK Products, Inc.
15250 E. Stafford Street
City of Industry • CA 91744
Tel: 800-356-2741 • 626-961-0413
Fax: 800-577-5771 • 626-336-2812
www.emtek.com

BX4-BROCHURE11
MARCH 2012